

# SPECIFICATION SHEET

COLLECTION: ASTRA

PRODUCT CODE: AX-AST-130+K-CP



WITH SHOWER KIT

Yes

WITH EASY-FIT BRACKETS

No

WITH INTEGRATED DIVERTER

No

WITH THERMOSTATIC TECHNOLOGY

No

FOR USE WITH BATH FILLER WASTE AND OVERFLOW

No

WITH BATH SPOUT

No

WITH AIR-INJECTION TECHNOLOGY

No

WITH WATER FLOW STRAIGHTENER

Yes

WITH WATER FLOW AERATOR

No

tel: 01934 744466  
email: [sales@vado.com](mailto:sales@vado.com)  
[www.vado.com](http://www.vado.com)

WHERE INSPIRATION FLOWS  
TAPS | SHOWERS | ACCESSORIES



# SPECIFICATION SHEET

COLLECTION: ASTRA

PRODUCT CODE: AX-AST-130+K-CP

## CONNECTIONS / FITTINGS

2 x 3/4" male threaded connections

## HANDLES

2 Handle

## SPARE PARTS

Standard cartridge C-102-STD

## DECK HOLE DRILL DIAMETER

27mm

## HOLES

2 Hole

## MOUNTING

Deck Mounted

## PLUMBING SYSTEM SUITABILITY

Gravity System, Pumped System, Combination Boiler, Pressurised System

## COLLECTION NAME

Astra

## FINISH

Chrome

## RECOMMENDED FLOW REGULATOR

FR-SHOWER/9-C/P

## MINIMUM OPERATING PRESSURE

0.2 Bar LP

## GUARANTEE

10 Year Guarantee

# TECHNICAL DRAWING

COLLECTION: ASTRA

PRODUCT CODE: AX-AST-130+K-CP

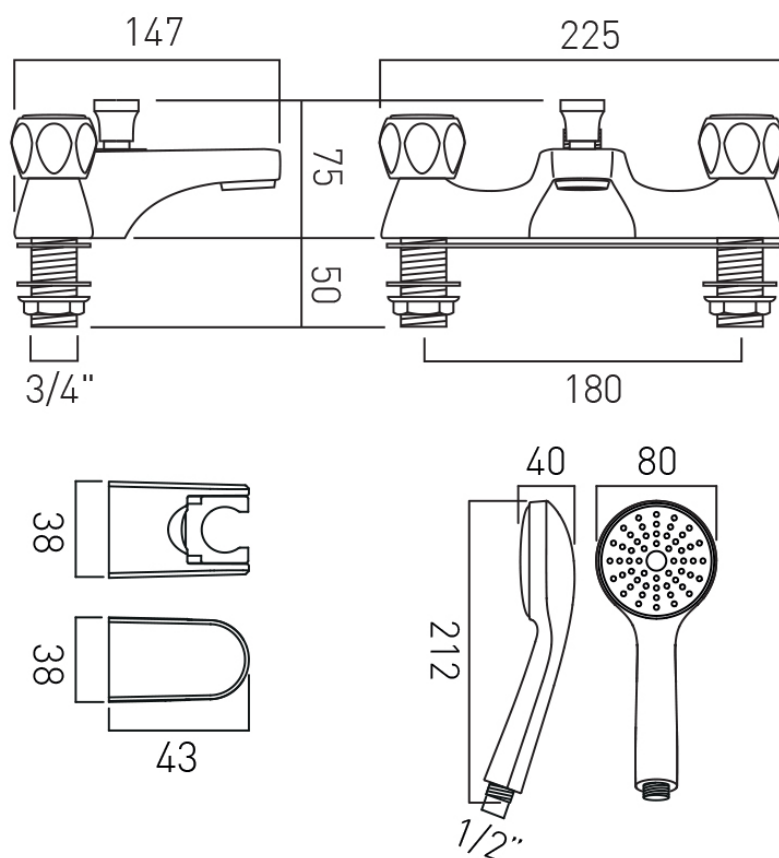

tel: 01934 744466  
email: [sales@vado.com](mailto:sales@vado.com)  
[www.vado.com](http://www.vado.com)

WHERE INSPIRATION FLOWS  
TAPS | SHOWERS | ACCESSORIES

