

SPECIFICATION SHEET

COLLECTION: ASTRA

PRODUCT CODE: AX-AST-130/CD+K-CP



PLUMBING SYSTEM SUITABILITY

Gravity System, Pumped System, Combination Boiler, Pressurised System

HANDLES

2 Handle

MOUNTING

Deck Mounted

WITH INTEGRATED DIVERTER

No

WITH EASY-FIT BRACKETS

No

WITH SHOWER KIT

Yes

WITH THERMOSTATIC TECHNOLOGY

No

FOR USE WITH BATH FILLER WASTE AND OVERFLOW

No

MINIMUM OPERATING PRESSURE

0.2 Bar LP

tel: 01934 744466
email: sales@vado.com
www.vado.com

WHERE INSPIRATION FLOWS
TAPS | SHOWERS | FURNITURE



SPECIFICATION SHEET

COLLECTION: ASTRA

PRODUCT CODE: AX-AST-130/CD+K-CP

MAXIMUM OPERATING PRESSURE

5.0 Bar HP

RECOMMENDED FLOW REGULATOR

FR-SHOWER/9-C/P

WITH BATH SPOUT

No

WITH AIR-INJECTION TECHNOLOGY

No

WITH WATER FLOW STRAIGHTENER

Yes

WITH WATER FLOW AERATOR

No

CONNECTIONS / FITTINGS

2 x 3/4" male threaded connections

DECK HOLE DRILL DIAMETER

27mm

SPARE PARTS

Cold Ceramic cartridge C-201-RTC Hot Ceramic cartridge C-201-LTC

FINISH

Chrome

COLLECTION NAME

Astra

GUARANTEE

10 Year Guarantee



TECHNICAL DRAWING

COLLECTION: ASTRA

PRODUCT CODE: AX-AST-130/CD+K-CP

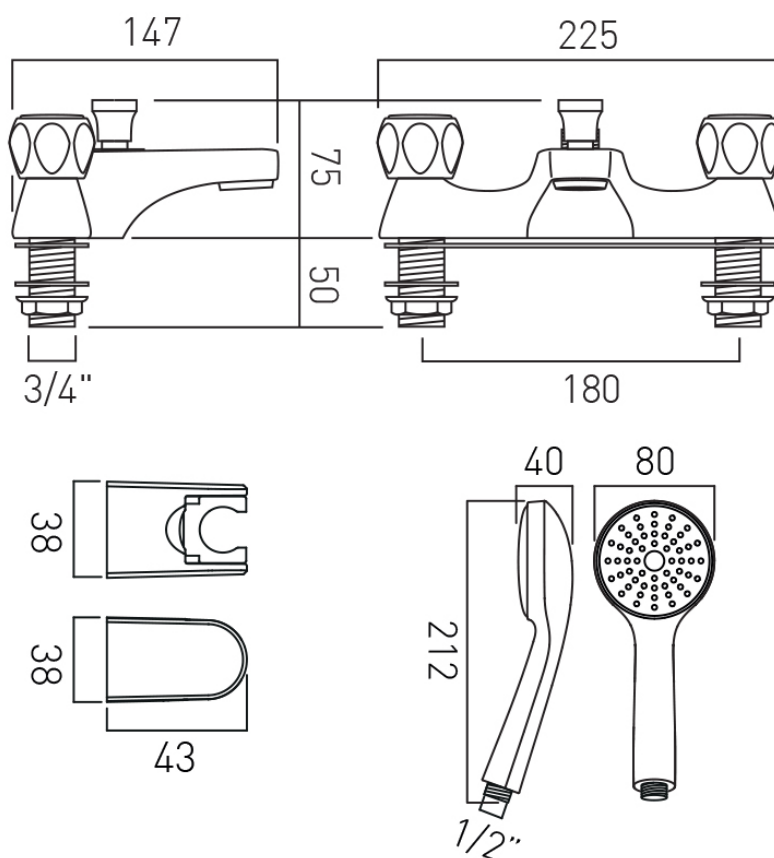

tel: 01934 744466
email: sales@vado.com
www.vado.com

WHERE INSPIRATION FLOWS
TAPS | SHOWERS | FURNITURE

