

SPECIFICATION SHEET

COLLECTION: PROFESSIONAL
PRODUCT CODE: AX-PRO-300-CP



TAP TYPE

Basin Mixer

FINISH

Chrome

COLLECTION NAME

Professional

GUARANTEE

10 Year Guarantee

PLUMBING SYSTEM SUITABILITY

Gravity System, Pumped System, Combination Boiler, Pressurised System

MINIMUM OPERATING PRESSURE

0.2 Bar LP

MAXIMUM OPERATING PRESSURE

5.0 Bar HP

HANDLES

1 Handle

MOUNTING

Deck Mounted

tel: 01934 744466
email: sales@vado.com
www.vado.com

WHERE INSPIRATION FLOWS
TAPS | SHOWERS | FURNITURE



SPECIFICATION SHEET

COLLECTION: PROFESSIONAL
PRODUCT CODE: AX-PRO-300-CP

RECOMMENDED FLOW REGULATOR

FR-100/5-PLA

WITH ECOTURN COLD START TECHNOLOGY

No

WITH WATER FLOW STRAIGHTENER

No

WITH WATER FLOW AERATOR

No

CONNECTIONS / FITTINGS

2 x 1/2" nut x 300mm flexible connections

DECK HOLE DRILL DIAMETER

35mm

SPARE PARTS

Ceramic Cartridge CAR-K40B

NOTES

Medical mixer



TECHNICAL DRAWING

COLLECTION: PROFESSIONAL
PRODUCT CODE: AX-PRO-300-CP

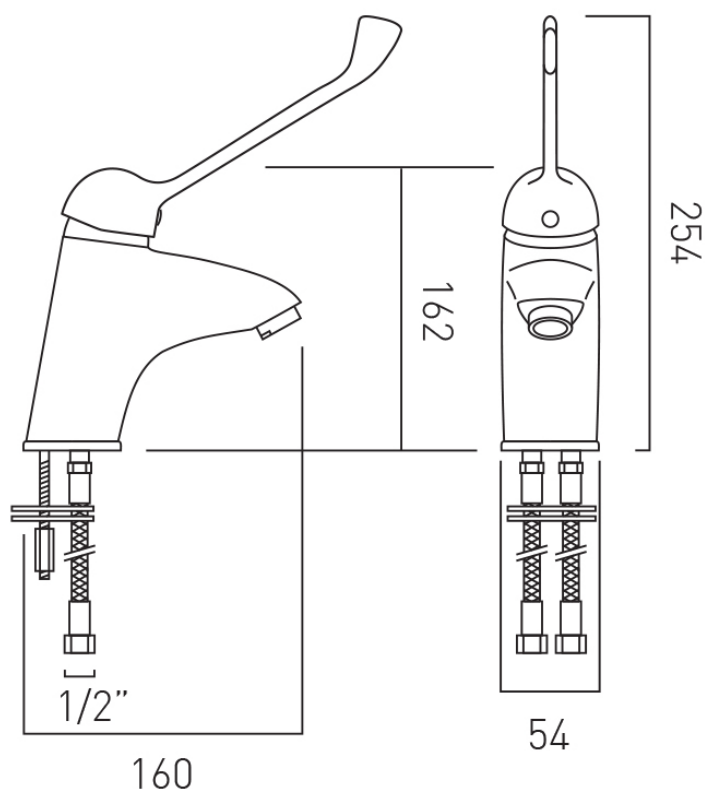

tel: 01934 744466
email: sales@vado.com
www.vado.com

WHERE INSPIRATION FLOWS
TAPS | SHOWERS | FURNITURE

